

8 7 6 5 4 3 2 1

已确认此版本的所有图纸

客户签名: \_\_\_\_\_ 日期: \_\_\_\_\_

REV	DESCRIPTION	DATE
1.0	首次设计;	2023-07-18

正视图

侧视图

背视图

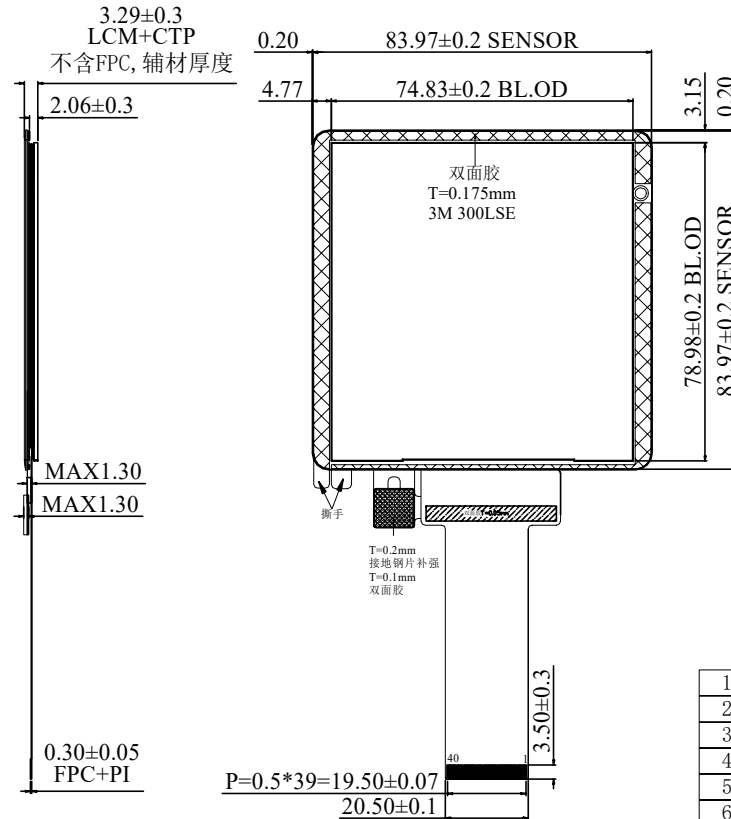
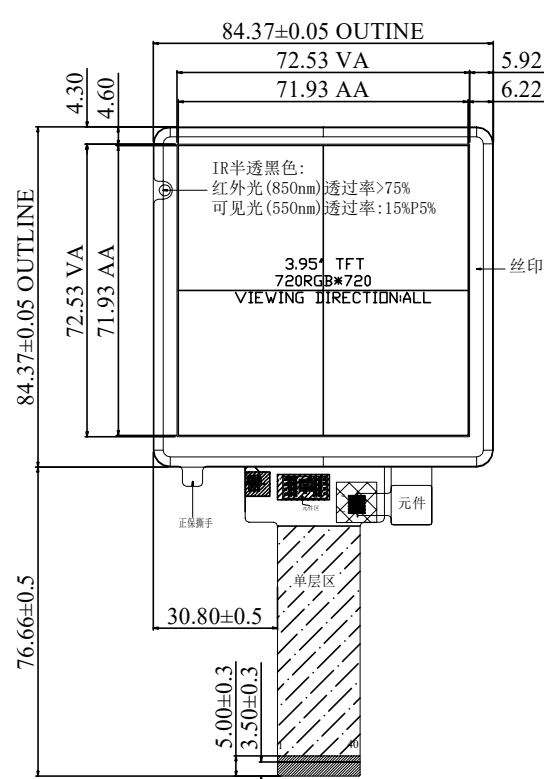

1	LEDA
2	LEDK
3	LEDK
4	GND
5	VCI
6	RESET
7	NC
8	NC
9	SDI
10	SCK
11	CS
12	PCLK
13	DE
14	VSYNC
15	HSYNC
16	DB0
17	DB1
18	DB2
19	DB3
20	DB4
21	DB5
22	DB6
23	DB7
24	DB8
25	DB9
26	DB10
27	DB11
28	DB12
29	DB13
30	DB14
31	DB15
32	DB16
33	DB17
34	GND
35	TP_INT
36	TP_SDA
37	TP_SCL
38	TP_RESET
39	TP_VCI
40	GND

- 技术参数:
- G+F+F; IC: FT5446U;
  - 玻璃盖板: 旭硝子T=0.7±0.05; 跌落测试: 64G钢球, 40cm高度中心点三次, 无碎裂情况
  - 透光率: ≥85%;
  - 表面硬度: ≥6H
  - 工作环境: -10°C~+60°C, ≤90%RH
  - 储存环境: -20°C~+70°C, ≤90%RH
  - 未注尺寸公差按±0.2mm
  - 产品环保符合ROHS标准

- Notes:
- Display Mode: 16.7M TFT/Normally Black
  - Viewing Angle: ALL
  - LCD Driver IC: NV3052C
  - Operating Temp: -10°C ~ +60°C
  - Storage Temp: -20°C ~ +70°C
  - \*:Critical Dimension, (:):Reference Dimension
  - Undefined Tolerance: ±0.2
  - Surface Luminance: TBD CD/M<sup>2</sup>(TYP)
  - Requirements on Environmental Protection: ROHS

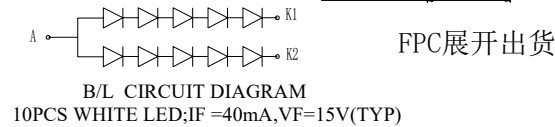

Kingtech Group Co.,Ltd.	TITLE:	ASSEMBLY	DO NOT SCALE THIS DRAWING, GENERAL TOLERANCE: ±0.2	
	PART NO.:	PV04014H0140N-C0		
	DRAWN BY:		DATE:	
	CHECKED BY:		DATE:	
	APPROVED BY:		DATE:	
		PROJECTION: OF		
		SCALE: N.T.S	UNIT: mm	